

## **BIM 101: AN INTRODUCTION TO BUILDING INFORMATION MODELING**

An AGC Construction Learning Tool

March 7, 2012

General Contractors Association of Hawaii

1065 Ahua Street, Honolulu, HI 96819

### Your Resource for Successful BIM Implementation

Building Information Modeling (BIM) is one of the most exciting developments in the construction industry and is changing the way projects are built.

Unit 1: BIM 101: An Introduction to Building Information Modeling

Session 1—What is BIM?

Session 2—BIM Visualization Uses and Spatial Coordination

Session 3—BIM Scheduling, Estimating and Facility Management

Session 4—Getting Started with BIM

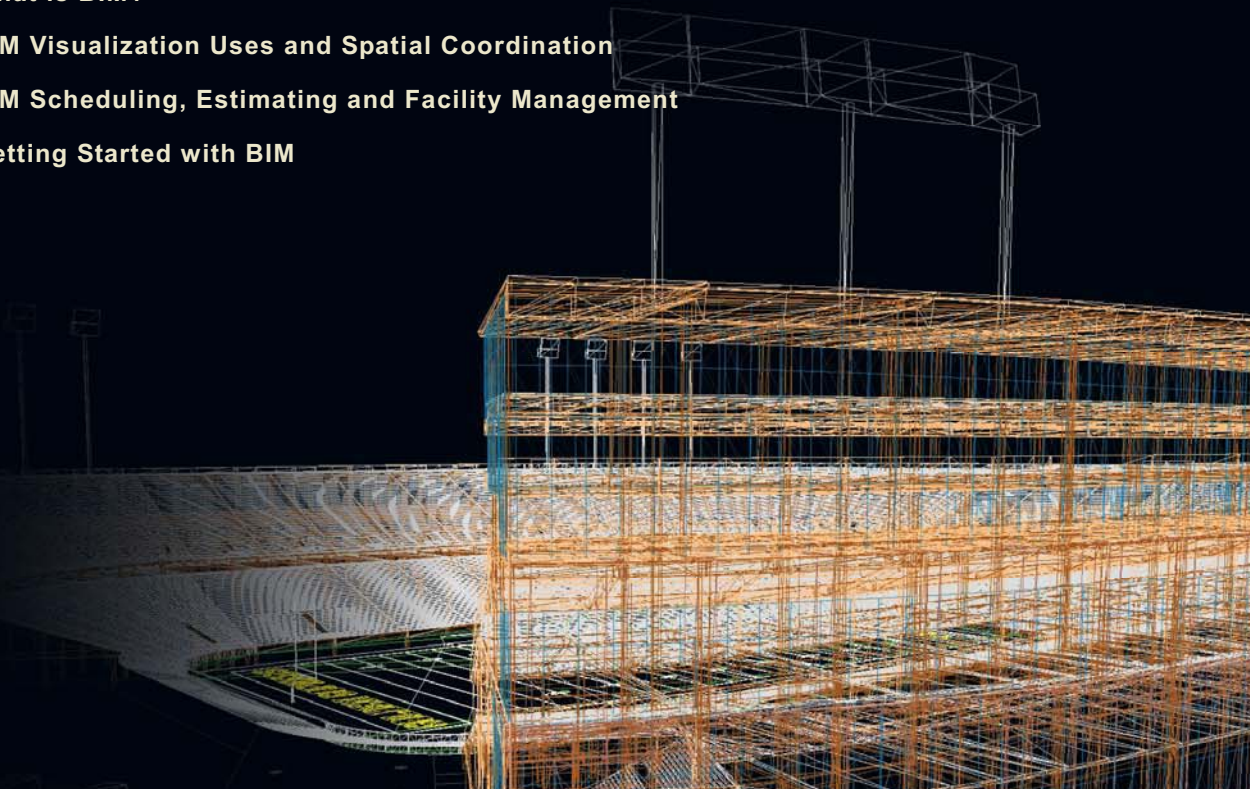

**LOCATION:** GCA Conference Room  
1065 Ahua Street, Honolulu  
**DATE:** March 7, 2012  
**TIME:** 7:30 a.m. - 5:00 p.m.  
**COST:** Member \$250 - Non Members \$450  
Continental Breakfast and lunch is included

**For more information**

[www.agc.org/BIMEP](http://www.agc.org/BIMEP)

**email | [gladys@gcahawaii.org](mailto:gladys@gcahawaii.org)**

**Phone | 808-833-1681 ext 24**

**FAX | 808-839-4167**

**AGC of America**  
THE ASSOCIATED GENERAL CONTRACTORS OF AMERICA

Quality People. Quality Projects.



## **BIM 101: AN INTRODUCTION TO BUILDING INFORMATION MODELING** An AGC Construction Learning Tool

### **BIM 101: An Introduction to Building Information Modeling**

BIM 101 is designed specifically for construction professionals eager to learn the essential concepts of BIM. Those who will also benefit include building developers, owners, managers, supervisors, architects, engineers, and construction product manufacturers. Students in the architecture, engineering and construction industry will also greatly benefit from this training.

The full-day course will give participants a comprehensive overview of BIM, supported by case studies to help participants comprehend each session's learning objectives. BIM 101 will introduce important concepts that will be necessary for future BIM courses.

#### Session 1—What Is BIM?

- Define common BIM terminology and BIM-related components
- Recognize differences between 2D CAD and 3D BIM
- Describe the evolution of BIM (past, present and future)
- Discuss how BIM is used in collaboration
- Discuss the benefits of BIM to all parties involved

#### Session 2—BIM Visualization Uses and Spatial Coordination

- Recognize the basics of the modeling process and model management protocol
- Recognize BIM uses in visualization, value analysis and scope clarification
- Explain the advantages of BIM in regards to spatial coordination

#### Session 3—BIM Scheduling, Estimating and Facility Management

- Recognize the advantages of BIM in scheduling and estimating
- Recognize how companies are using BIM in facility management
- Explain the benefits to and lessons learned from companies using BIM

#### Session 4—Getting Started with BIM

- Identify challenges for getting started with BIM
- Demonstrate a basic understanding of BIM tools
- Develop a BIM Action Plan
- Use BIM resources provided to further understanding of more advanced BIM concepts and practice

**LOCATION:** GCA Conference Room  
1065 Ahua Street, Honolulu  
**DATE:** March 7, 2011  
**TIME:** 7:30 a.m. - 5:00 p.m.  
**COST:** Member \$250 - Non Members \$450  
Continental Breakfast and lunch is included

#### For more information

[www.agc.org/BIMEP](http://www.agc.org/BIMEP)

**email | [gladys@gcahawaii.org](mailto:gladys@gcahawaii.org)**

**Phone | 808-833-1681 ext 24**

**FAX | 808-839-4167**



# GCA of Hawaii

GENERAL CONTRACTORS ASSOCIATION OF HAWAII

Quality People. Quality Projects.

# BIM

EDUCATION  
PROGRAM

The General Contractors Association of Hawaii Presents:

## BIM 101: AN INTRODUCTION TO BUILDING INFORMATION MODELING

March 7, 2012

### Registration Form

NAME:		TITLE:	
Company:			
Address:			
City:		State/ZIP	
Phone:		FAX:	
Cell:		AGCID#:	
Email:			

**LOCATION :** The course will be held at GCA Conference Room, 1065 Ahua Street, Honolulu, HI 96819

**TIME:** 7:30 a.m. – 5:00 p.m.

**PAYMENT INFORMATION:** (Payment must accompany registration to secure your seat)  
Registration fee includes Continental Breakfast, lunch and the Participant’s Manual for the course.

**Registration Deadline and Cancellation policy:**

The registration deadline for this program is January 13, 2012. Full refunds will be made for cancellations received prior to that date. After that date, no refunds will be granted. Replacements accepted.

**Registration Fees:**

\$250 for members                       \$450 for non-members

Enclosed is a check for \$ \_\_\_\_\_ made payable to GCA of Hawaii

Charge my credit card \$ \_\_\_\_\_ (See attached CC Form)

1065 Ahua Street  
 Honolulu, HI 96819  
 Phone: 808-833-1681 FAX: 839-4167  
 Email: [info@gcahawaii.org](mailto:info@gcahawaii.org)  
 Website: [www.gcahawaii.org](http://www.gcahawaii.org)



# GCA of Hawaii

GENERAL CONTRACTORS ASSOCIATION OF HAWAII

Quality People. Quality Projects.

**PLEASE FAX WITH YOUR  
 REGISTRATION FORM TO:  
 839-4167**

<b>CREDIT CARD AUTHORIZATION FORM</b>			
NAME ON CARD:			
COMPANY:			
BILLING ADDRESS:			
CITY/STATE/ZIP			
PHONE:		FAX:	
AMOUNT:			
CREDIT CARD TYPE:			
<input type="checkbox"/> VISA	<input type="checkbox"/> MC	<input type="checkbox"/> AMEX	<input type="checkbox"/> DISCOVER
CARD NUMBER:			
EXP. DATE:		CODE:	
EVENT & LOCATION:			
DATE OF EVENT:			
SIGNATURE:		DATE:	
CONTACT PERSON			

<input type="checkbox"/> Check box to request credit card receipt to be emailed @ _____
<input type="checkbox"/> Check box to request original credit card receipt to be mailed.
<input type="checkbox"/> Check box to request copy of credit card receipt to be faxed.

<i>FOR GCA OFFICE ONLY:</i>
<i>RECEIVED BY:</i>
<i>DATE:</i>